



CUSTOM HEADREST
SOLD SEPARATELY

Multi-Axis Offset Headrest Hardware

- Adjusts horizontally, vertically, and pivots on a ball
- Features a positioning stop collar which allows you to remove the headrest assembly without changing the desired headrest position
- Mounting plate is compatible with both 1 7/8" and 2" on center hole spacing
- Use with any headrest pad on page 30-31 (sold separately)

Multi-Axis Offset
Headrest Hardware50215



HEADREST PAD SOLD SEPARATELY

Surelock Square Bar Headrest Hardware

- Positive locking joints allow for easy adjustment
- Features a positioning stop collar which allows you to remove the headrest assembly without changing the desired headrest position
- Mounting plate is compatible with both 1 7/8" and 2" on center hole spacing
- Use with any headrest pad on page 30-31 (sold separately)

Surelock Square Bar
Headrest Hardware50218

Surelock Square Bar Headrest Hardware

PARTS DESCRIPTION

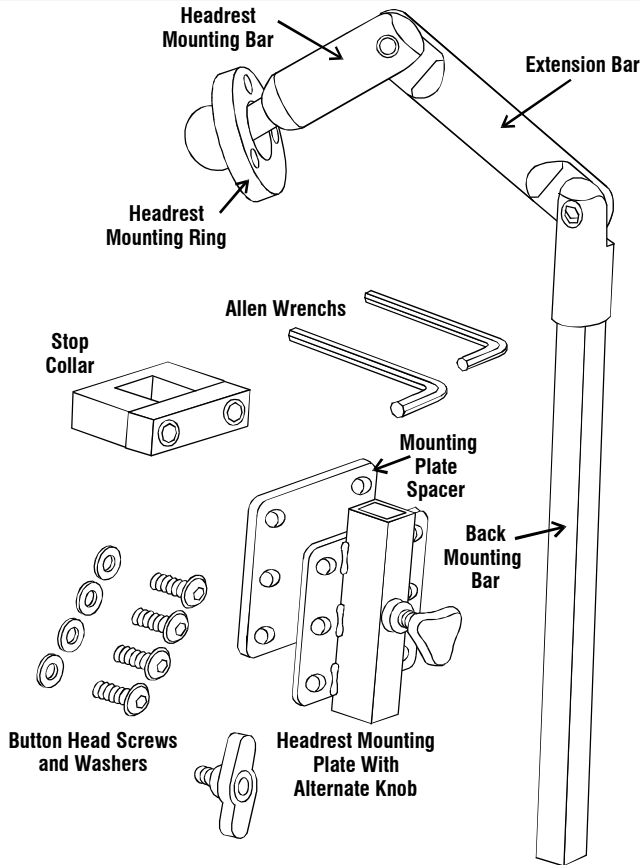

ASSEMBLY AND ADJUSTMENTS

1. Use 4 buttonhead screws and washers (included) to attach **mounting plate and spacer** to chair. Make sure all six holes of plate and spacer line up. The on-center hole dimensions of the **mounting plate** are shown here.

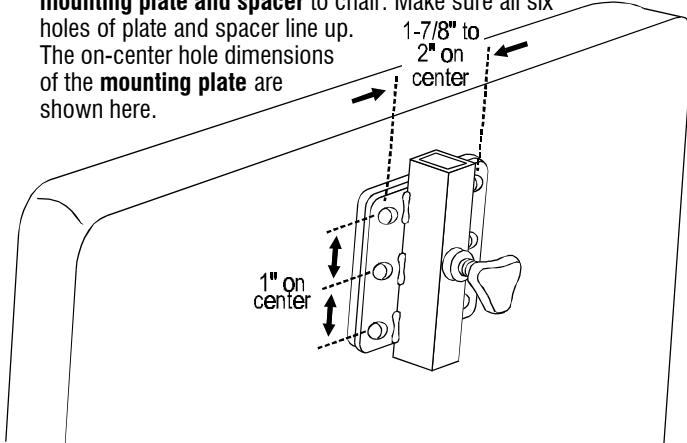

2. If desired, loosen set screws on **stop collar** and slide it onto the bar. Make sure **stop collar set screws** are accessible from the back side of the chair. Slide headrest assembly into **mounting plate**. Adjust assembly to desired vertical position, Tighten **knob**.
3. If using **stop collar**, position it so it sits on the top of the **mounting plate**. With allen wrench, tighten **set screws**.

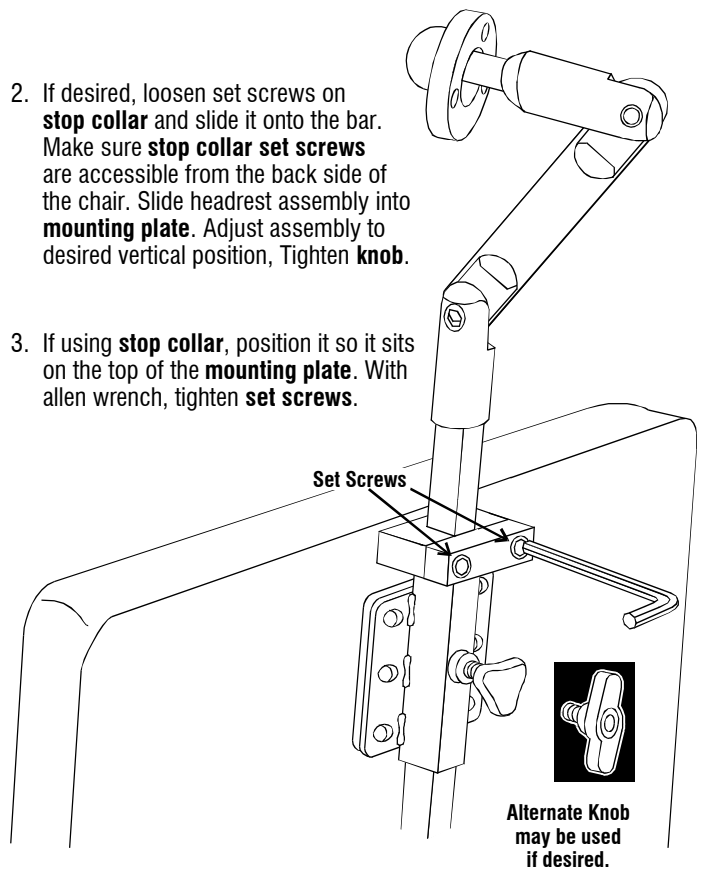

3. Loosen screws and adjust headrest assembly into desired position. If shorter assembly is desired, remove screws, and remove **extension bar**. Tighten screws.

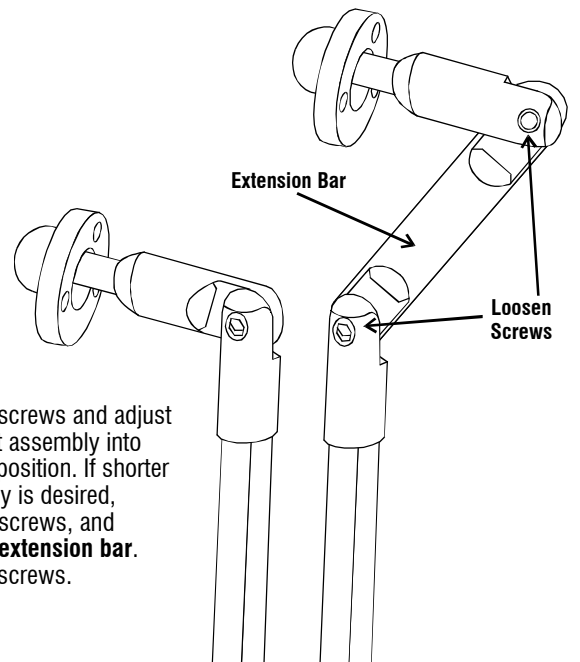

4. Place headrest on ball at end of **headrest mounting bar**. Slide **mounting ring** over ball and tighten screws so headrest stays in desired position.

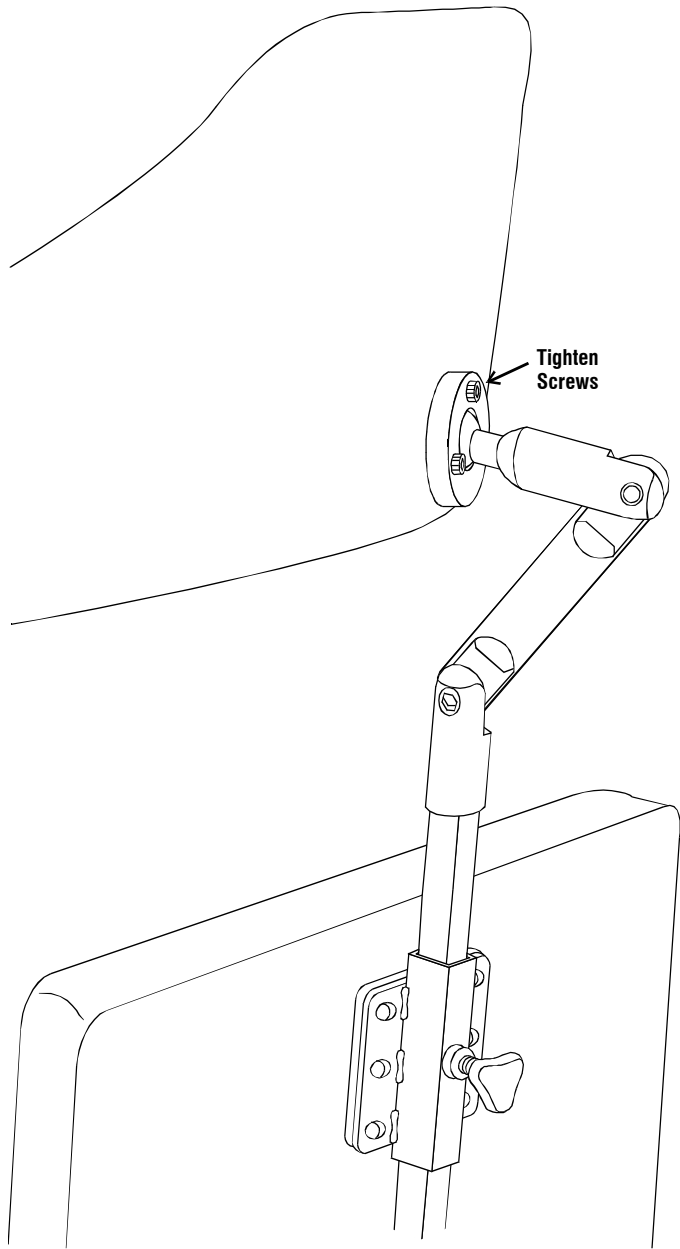

Multi-Axis Offset Headrest Hardware

PARTS DESCRIPTION

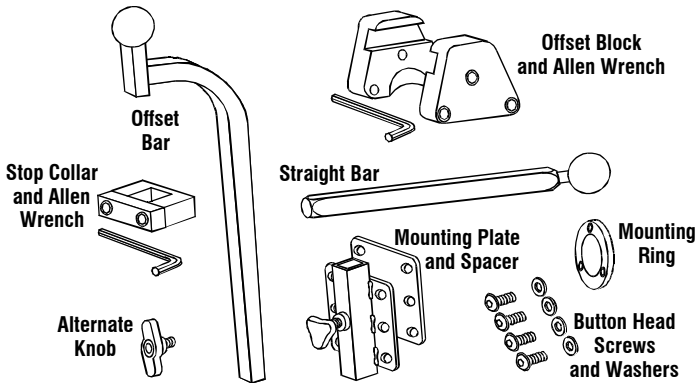

ASSEMBLY AND ADJUSTMENTS

1. Use 4 buttonhead screws and washers (included) to attach **mounting plate and spacer** to chair. Make sure all six holes of plate and spacer line up. On-center hole dimensions shown here.

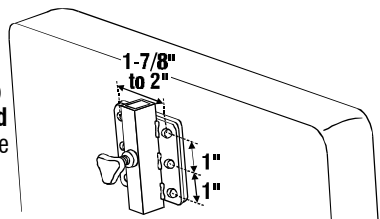

2. If desired, loosen set screws on **stop collar** and slide it onto **offset bar**. Make sure **stop collar set screws** are accessible from the back side of the chair. Slide **offset bar** into **mounting plate**. Adjust vertically. Tighten **knob**. The **alternate knob** may be used if desired.

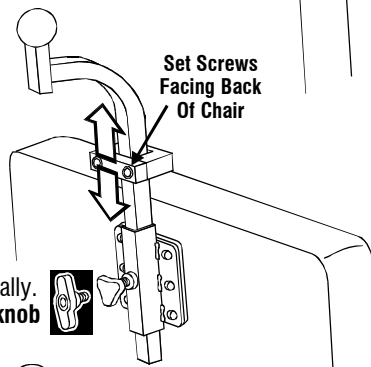

3. If using **stop collar**, position it so it sits on the top of the **mounting plate**. With allen wrench, tighten set screws.

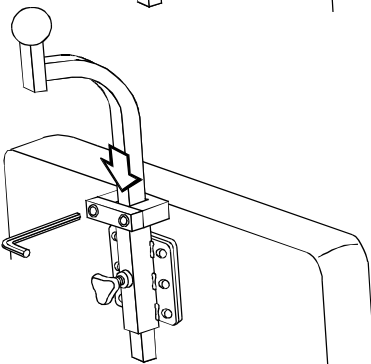

4. Place **offset block** over ball on **offset bar**. Adjust angle. Hand tighten socket-head bolts.

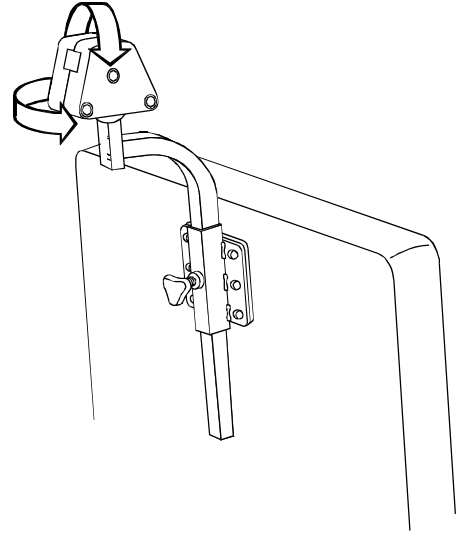

5. Slide **straight bar** through **mounting ring**, and then into **offset block**. Adjust horizontally. With allen wrench, tighten all 3 socket-head bolts with equal pressure.

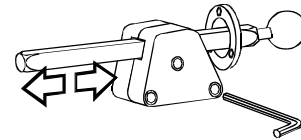

6. Place headrest on ball at end of **straight bar**. Adjust angle. Slide **mounting ring** over ball and tighten socket-head bolts into headrest.

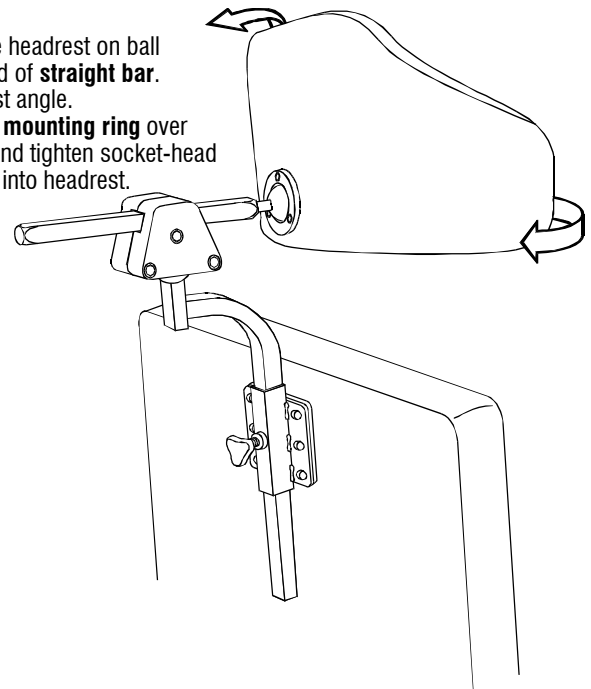

08748